

TB-20,20F



- | | | | |
|-----------|---------------|------------|-----------------|
| Bucket | Float | Disc | Bellows |
| Bimetal | Wafer | By-pass | Stainless steel |
| Connector | Right to Left | Down to Up | Up to Down |



TB-20



TB-20F

5
Steam Trap

■Features

1. Excellent durability ensured by unique internal structure (hemispherical valve, etc).
2. The upper plug is made of stainless steel, and is excellent in wear resistance.
3. Reliable performance due to all stainless steel made internal parts and the unique internal structure.
4. Super energy saving since intermittent operation removes air adiabatic wall in the heat exchanger and increases heat efficiency considerably.

■Specifications

Model		TB-20	TB-20F	
Nominal size		15A, 20A, 25A		
Connection		JIS Rc screwed	JIS 20K FF flanged	JIS 10K FF flanged
Application		Steam condensate		
Maximum pressure		2.0 MPa		1.0 MPa
Max. differential pressure	(A)	0.3 MPa		
	(B)	0.6 MPa		
	(C)	1.0 MPa		
	(D)	1.6 MPa	-	
Max. temperature		220°C		
Material	Body	Ductile cast iron		
	Valve	Stainless steel (heat treated)		
	Valve seat	Stainless steel (heat treated)		

· Available with ASME and EN flanged.

■Discharge Capacity Chart

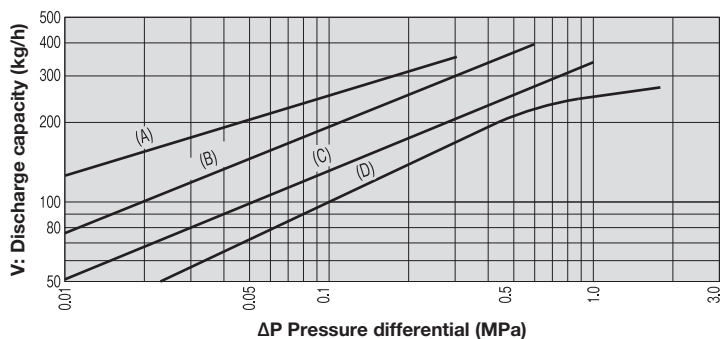

- The discharge capacity shown here is a continuous discharge capacity at the indicated differential pressure.
- In general, select a steam trap with a safety factor twice or threefold the regular level.

■Dimensions (mm) and Weights (kg)

· TB-20

Nominal size	L	H	H ₁	A	Weight
15A	136	183	94	117	4.3
20A					
25A					

· TB-20F

Nominal size	L	H	H ₁	A	Weight
15A	175	183	94	117	5.4
20A					6.0
25A					6.3

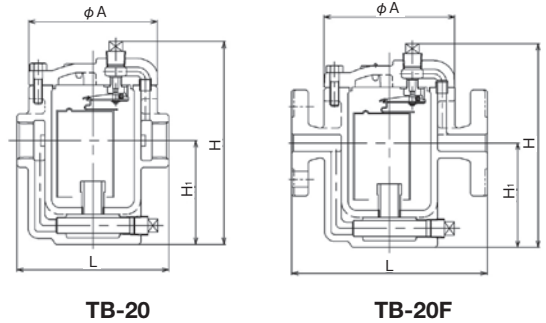

- The dimensions of the product with JIS 10K FF flanged and the product with JIS 20K FF flanged are identical.
- The thickness of JIS 10K FF flanges conforms to that of JIS 20K FF flanges.

■Exploded View

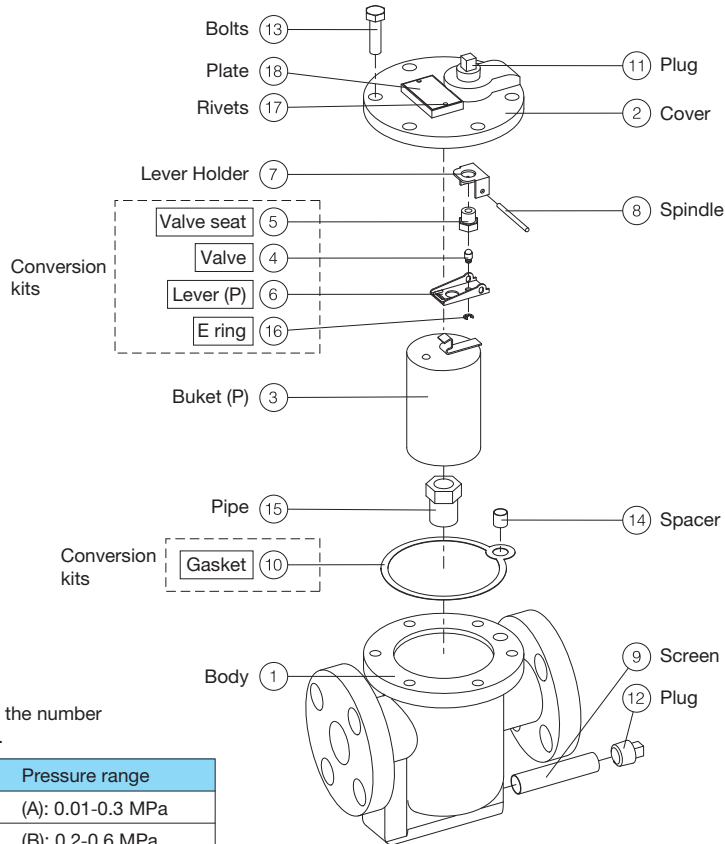

Refer to below table on the number of each conversion kits.

No.	Pressure range
K-93070	(A): 0.01-0.3 MPa
K-93071	(B): 0.2-0.6 MPa
K-93072	(C): 0.3-1.0 MPa
K-93073	(D): 0.6-1.6 MPa

* Part names shown in boxes are consumable items.

TB-5



Bucket	Float	Disc	Bellows
Bimetal	Wafer	By-pass	Stainless steel
Connector	Right to Left	Down to Up	Up to Down

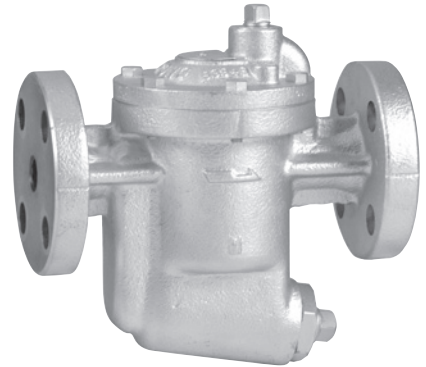

■Features

1. Excellent durability ensured by unique internal structure (free floating lever system, spherical valve, etc).
2. Reliable performance due to all stainless steel made internal parts and the unique internal structure.
3. Superior energy saving since intermittent operation removes air adiabatic wall in the head exchanger and increases heat efficiency considerably.
4. Distinguished scale resistance provided by built-in strainer and dual separation system.
5. Wide variety of options, including large vent and built-in type check valve.

■Specifications

Model		TB-5
Maximum pressure		1.0 MPa
Maximum working differential pressure		Refer to "Discharge Capacity Chart"
Max. temperature		220°C
Material	Body	Ductile cast iron
	Valve, valve seat	Stainless steel
	Bucket	Stainless steel
Connection		JIS 10K FF flanged
Nominal size		15A-50A

■Orifice Size

Max. working differential pressure MPa

	Nominal size	
	15A-25A	32A-50A
3/8 (9.5mm)	—	0.21
9/32 (7.1mm)	—	0.56
1/4 (6.4mm)	—	0.87
7/32 (5.6mm)	—	1.0
1/8 (3.2mm)	0.56	—
7/64 (2.8mm)	0.87	—
#38 (2.5mm)	1.0	—

■Discharge Capacity Chart

(The charts below show the discharge capacity of saturated condensate in actual operation.)

· 15A-25A

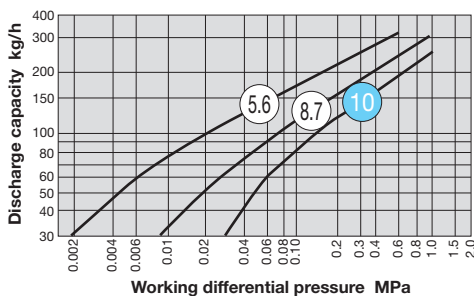

· 32A-50A

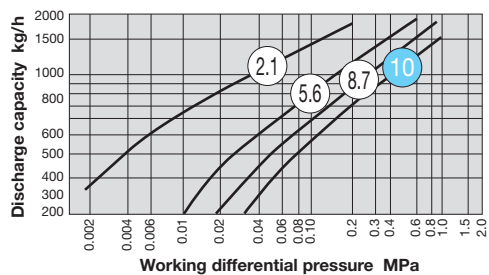

- The discharge capacity shown here is a continuous discharge capacity at the indicated differential pressure.
- In general, select a steam trap with a safety factor twice or threefold the regular level.
- The circled values are maximum working differential pressures (kgf/cm²). (The values in white circles represent a standard product, and those in a green circle denote a custom-made product.)

■Dimensions (mm) and Weights (kg)

Nominal size	L	H	H ₁	Plug	Weight
15A	175	177	98	NPT 3/8	4.5
20A	195	177	98	NPT 3/8	4.9
25A	215	177	98	NPT 3/8	6.2
32A	280	336	190	NPT 1/2	18.3
40A	280	336	190	NPT 1/2	18.7
50A	290	336	190	NPT 1/2	19.6

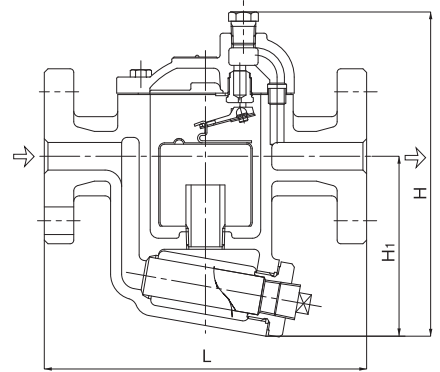

■Options

(The options listed below are made-to-order items. For further information, please contact us.)

- Large vent (LV)
- Thermic vent bucket (T)
- Scrub wire (VW)
- Built-in type check valve (V)

* Only either a built-in type check valve or a thermic vent bucket can be installed on 15A to 25A steam traps.

■Exploded View

